

SCALE BAR @1:50

FLOOR PLAN SCALE 1:50

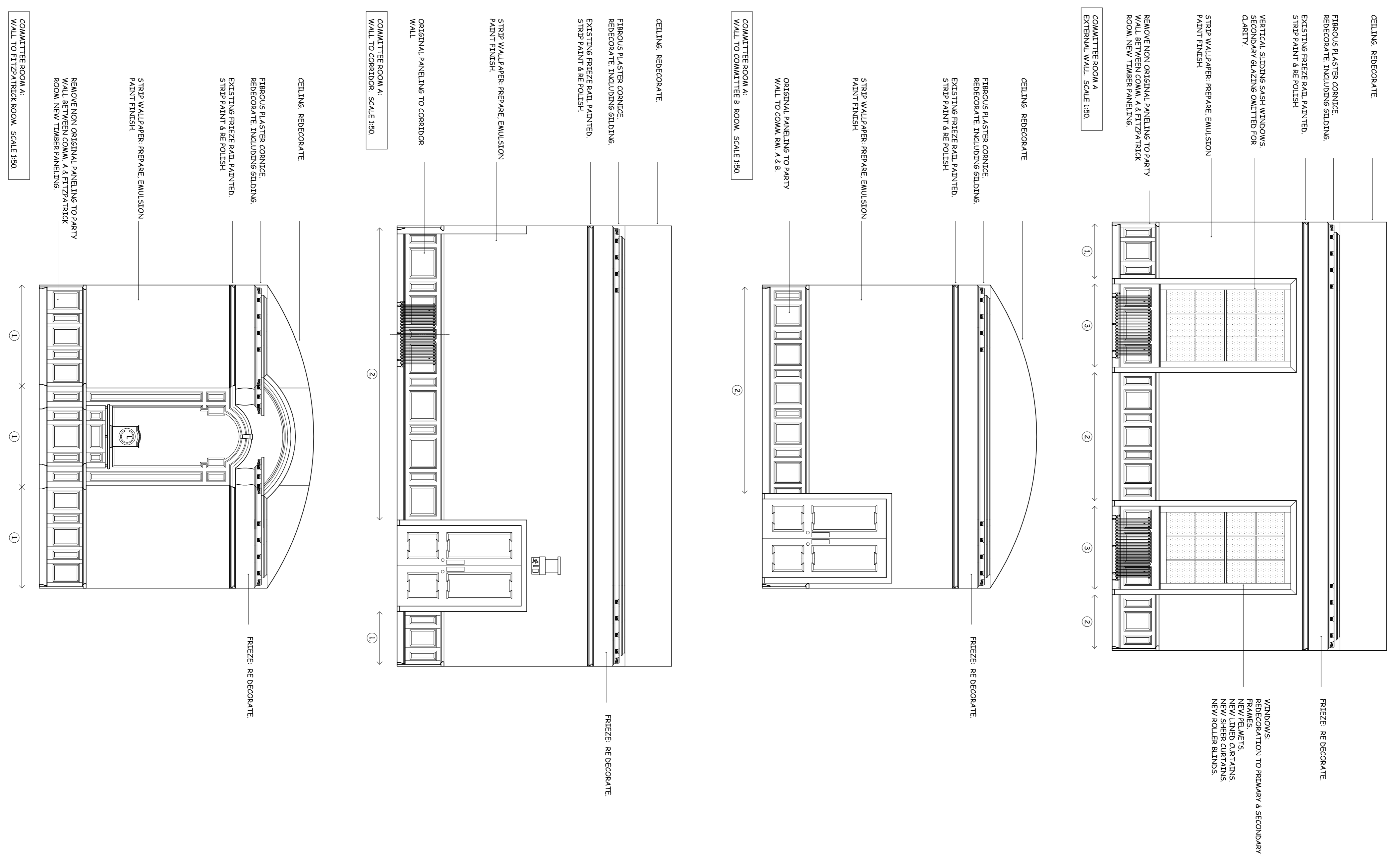
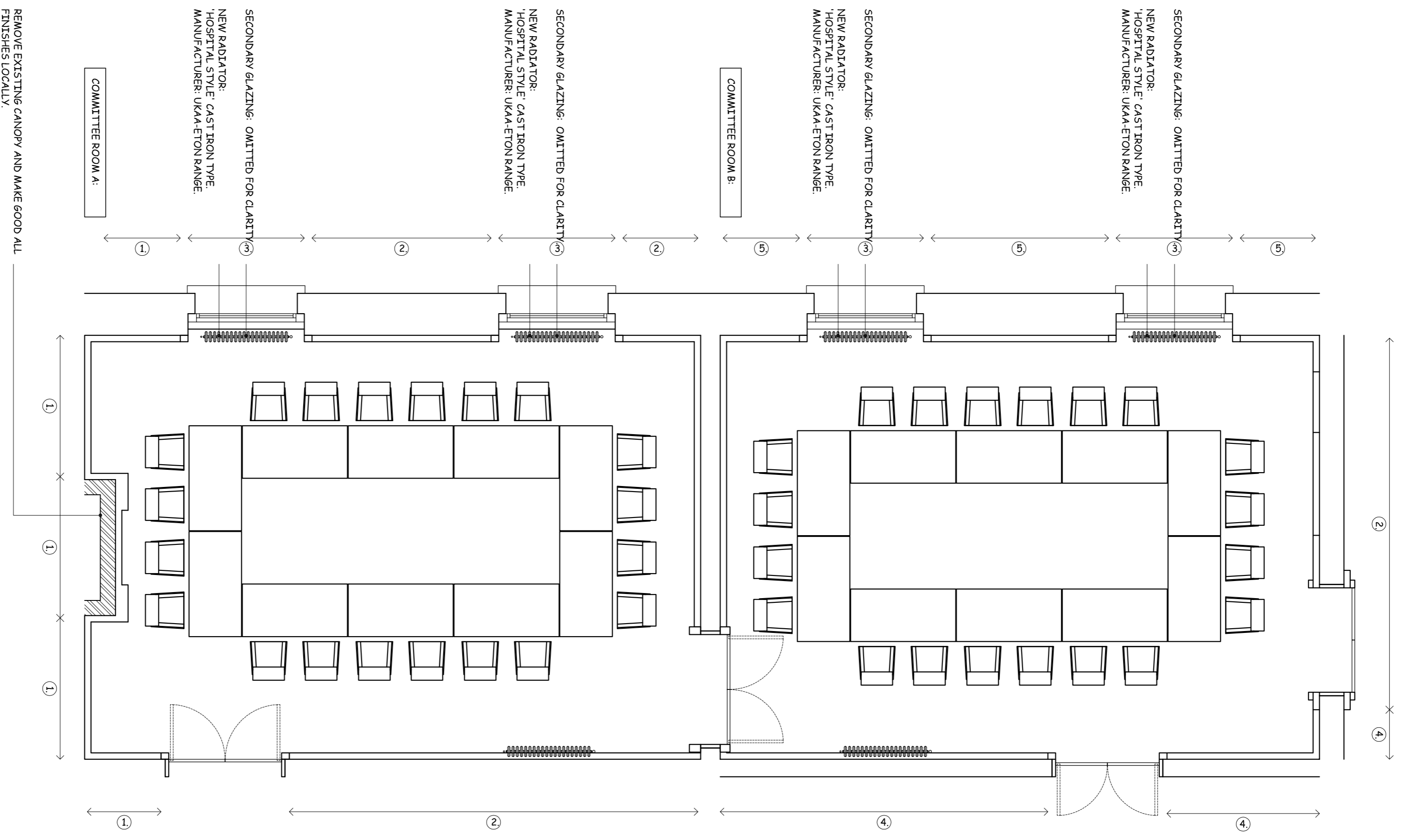

| Rev | Date       | Description                    | CMR |
|-----|------------|--------------------------------|-----|
| 8   | 09/02/2015 | CONNECTORS OMITTED - RADIATORS |     |
| 4   | 23/04/2014 | NOTES ADDED                    |     |
| 7   | 04/2014    | L.B.C. SUBMISSION              |     |

|  |  |
|--|--|
| <p>David Garrard - Corporate Director<br/>                 Director of Regeneration, South Shields, Tyne &amp; Wear, NE33 2RL<br/>                 Telephone: (0191) 427117 Fax: (0191) 455770</p> |  |
| <p><b>South Tyneside Council</b><br/>                 Economic Regeneration</p>  |  |
| Project  | TOWN HALL<br>WESTOUE ROAD<br>SOUTH SHIELDS<br>NE33 2RL |
| Drawing Title  | COMMITTEE ROOM A                                       |
| Drawn by   | P.C.   |
| Checked by   | Date: 06/01/2014                                       |
| Scale  | 1:50 Size A1   |
| Project Code   | AD 5421  |
| Drawing Number   | L(2)- 10B  |

**GENERAL NOTES:**

- 1 REMOVE EXISTING PLY PANELLING WITH PLANTED MOULDINGS. HACK OFF ALL EXISTING BACKING PLASTER
- 2 EXISTING DABO PANELLING RETAINED.
- 3 NEW RADIAATORS: "HOSPITAL STYLE" CAST IRON TYPE. MANUFACTURER UKA-ETON RANGE (OR EQUAL & APPROVED).
- 4 NEW TIMBER DABO PANELLING WITH TO MATCH EXISTING. INCLUDING DABO RAIL, SKIRTING AND TIMBER PANELLING FEATURING RAISED AND FIELDED PANELS ETC.
- 5 NEW TIMBER DABO PANELLING WITH TO MATCH EXISTING. INCLUDING DABO RAIL SKIRTING AND TIMBER PANELLING FEATURING RAISED AND FIELDED PANELS ETC.

WINDOWS:  
 REDECORATION TO PRIMARY & SECONDARY FRAMES  
 NEW LINED CURTAINS  
 NEW ROLLER BLINDS

CEILING: REDECORATE  
 FERROUS PLASTER CONCRETE  
 REDECORATE INCLUDING GILDING.  
 EXISTING FRIEZE PAUL PAINTED.  
 STRIP PAINT & RE POLISH.  
 VERTICAL SLIDING SASH WINDOWS  
 SECONDARY GLAZING OMITTED FOR CLARITY.  
 STRIP WALLPAPER: REPAIR/RE EMULSION PAINT FINISH.  
 REMOVE NON ORIGINAL PANELLING TO PARTY WALL BETWEEN COMM. A & FITZPATRICK ROOM. NEW TIMBER PANELLING.

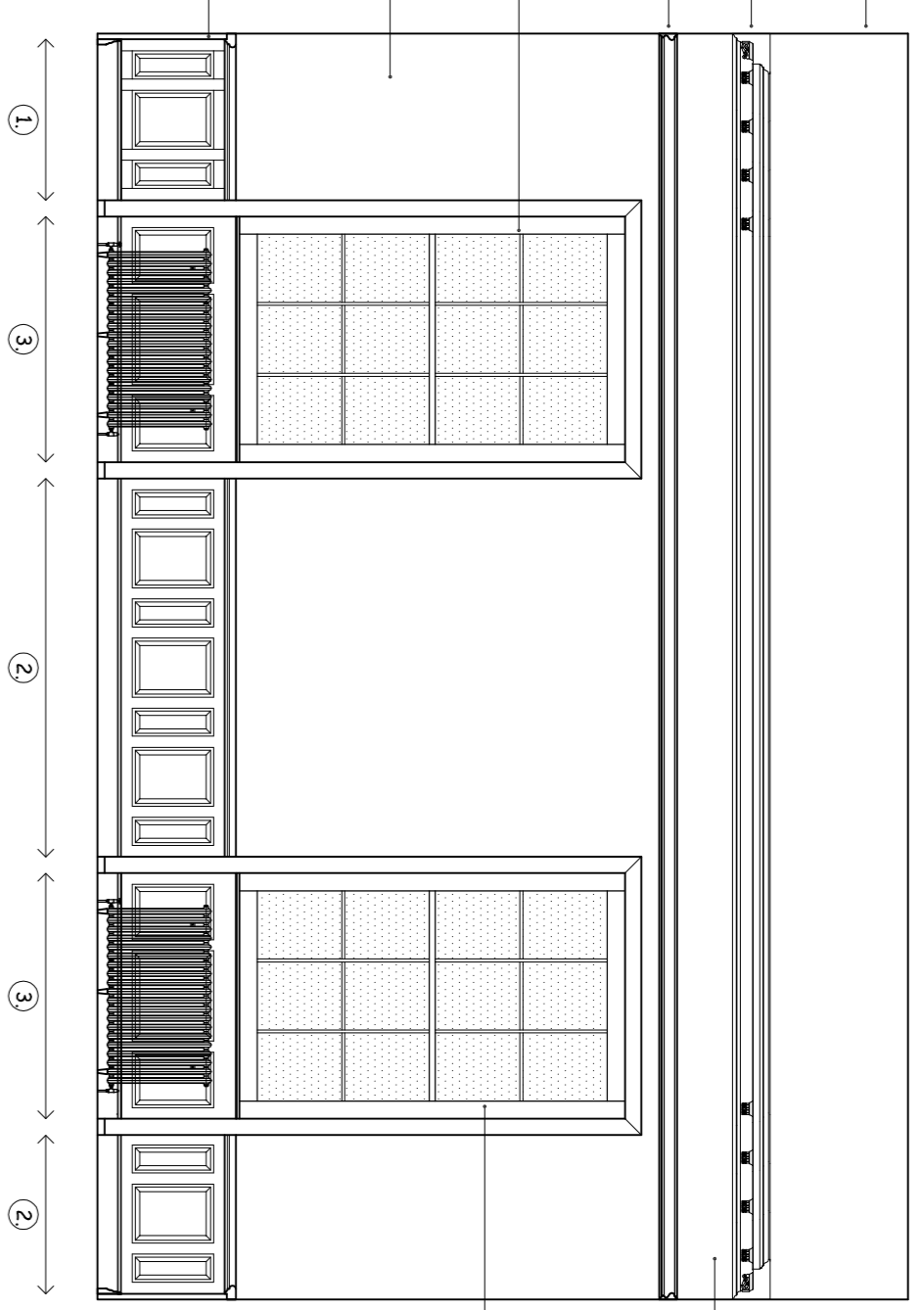

COMMITTEE ROOM A  
 EXTERNAL WALL. SCALE 1:50.

CEILING: REDECORATE  
 FERROUS PLASTER CONCRETE  
 REDECORATE INCLUDING GILDING.  
 EXISTING FRIEZE PAUL PAINTED.  
 STRIP PAINT & RE POLISH.  
 STRIP WALLPAPER: REPAIR/RE EMULSION PAINT FINISH.

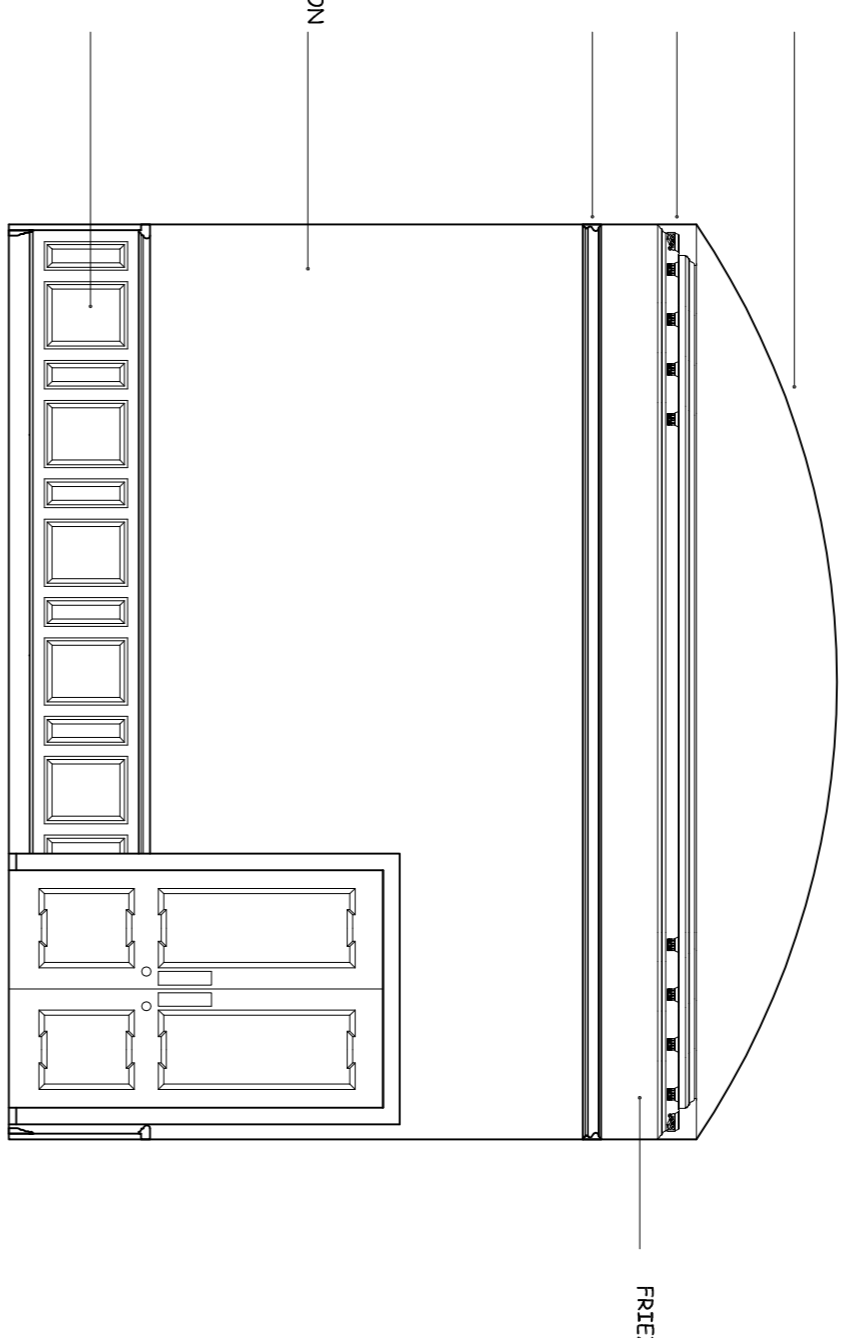

COMMITTEE ROOM B  
 WALL TO COMMITTEE B ROOM. SCALE 1:50.

CEILING: REDECORATE  
 FERROUS PLASTER CONCRETE  
 REDECORATE INCLUDING GILDING.  
 EXISTING FRIEZE PAUL PAINTED.  
 STRIP PAINT & RE POLISH.  
 STRIP WALLPAPER: REPAIR/RE EMULSION PAINT FINISH.

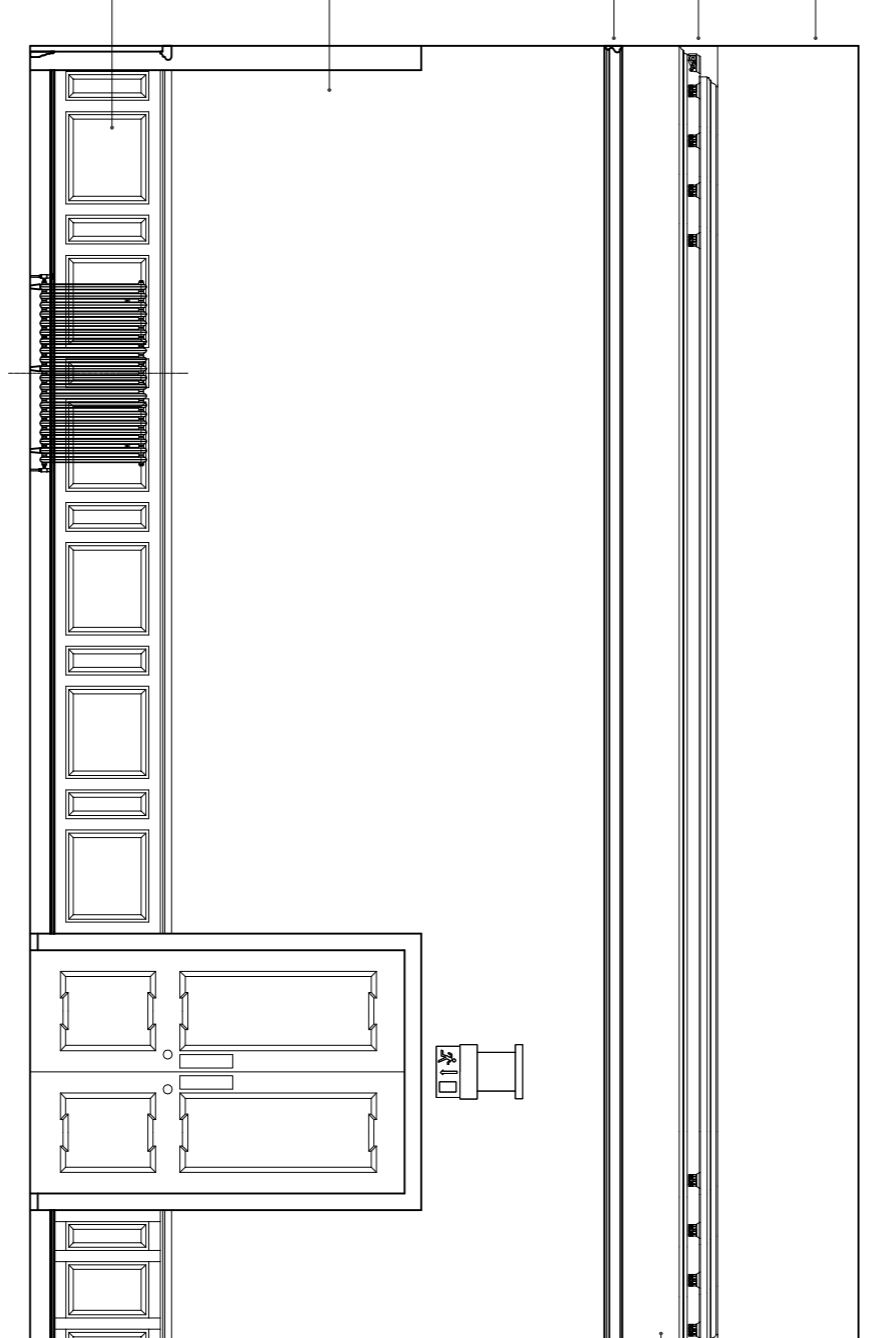

COMMITTEE ROOM A:  
 WALL TO CORRIDOR. SCALE 1:50.

CEILING: REDECORATE  
 FERROUS PLASTER CONCRETE  
 REDECORATE INCLUDING GILDING.  
 EXISTING FRIEZE PAUL PAINTED.  
 STRIP PAINT & RE POLISH.  
 STRIP WALLPAPER: REPAIR/RE EMULSION PAINT FINISH.

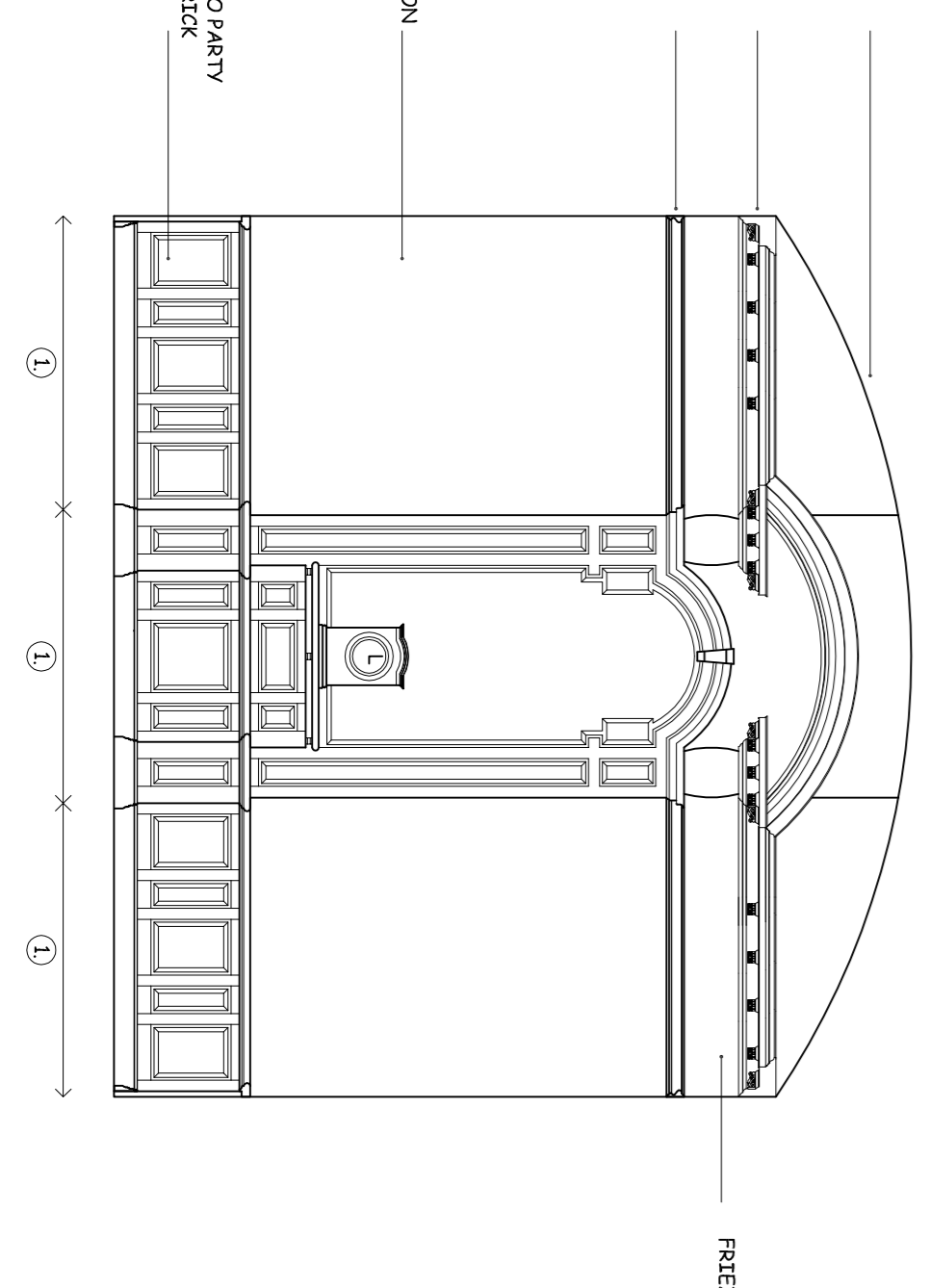

COMMITTEE ROOM A:  
 WALL TO FITZPATRICK ROOM. SCALE 1:50.